



# EURO VISTA PIVOT™

ALUMINUM & WOOD PIVOT DOORS



Approved for use in Miami-Dade HVHZ Zones  
Florida Building Code Approved  
Product Approval FL 22410

[www.euro-wall.com](http://www.euro-wall.com)  
888.989.EURO (3876)

**euro-wall®**



FOLDING

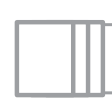

SLIDING



STACKING

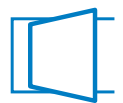

PIVOT

# SYSTEM THRESHOLDS

## Maximum / Minimum Specifications

Max Panel Weight:	700 lbs
Min Panel Width:	36"
Max Panel Width:	96"
Min Panel Height:	48"
Max Panel Height:	144"
Panel Thickness:	2-1/4" to 3-1/2"

**NOTE:** The Euro Pivot™ Door comes in aluminum, aluminum with wood clad, wood and wood with aluminum clad options. The Euro Pivot™ door can also be configured with either an outswing or an inswing. Solid wood pivot doors are not Florida Product Approved and are not impact rated. For installations in Florida, please see the Florida Product Approval for usage and limitations.

## SYSTEM HIGHLIGHTS

### Aluminum Pivot Panel Specifications

Extruded aluminum 6063-T5 with door panel corner keys for strength and security / optional wood clad finish available

### Wood Pivot Panel Specifications

From 2-1/4" - 3-1/2" thick / optional aluminum clad finish available in AAMA 2604 and 2605

### Hardware

Stainless steel (316/304SS) components with aluminum hinges

### Lever Lock Sets

Top and bottom shootbolt locking system

### Multi-point Door Locks

Faceplate, latch and hooks are 304SS

### No Sills

No sills necessary

### Matching Fixed Units

Matching Florida Product Approved impact rated transom and sidelight units available

### Largest Impact Rated Panel Sizes

144" tall / 72" wide panels - the largest available HVHZ impact tested and Florida Product Approved pivot door

### Under Pressure

Highest design pressure available for any impact rated pivot door - up to 60+/-

### Aesthetics

Muntins, simulated divided lites, mid-rails, custom wood cladding, custom aluminum cladding . . . a multitude of customization options allow for flexible and functional design

### Ladder Pull

Available in sizes ranging from 1' - 8' to meet the needs of your application

### Self Closure

Hydraulic self closure option available

### Long Lasting Finish

Standard finish coating is AAMA 2605, the highest quality finish available

# SYSTEM COMPONENTS / OPERATION

*(Aluminum pivot door shown below; configurations are valid for all pivot door types)*

## TOP VIEW - Horizontal Cross Section

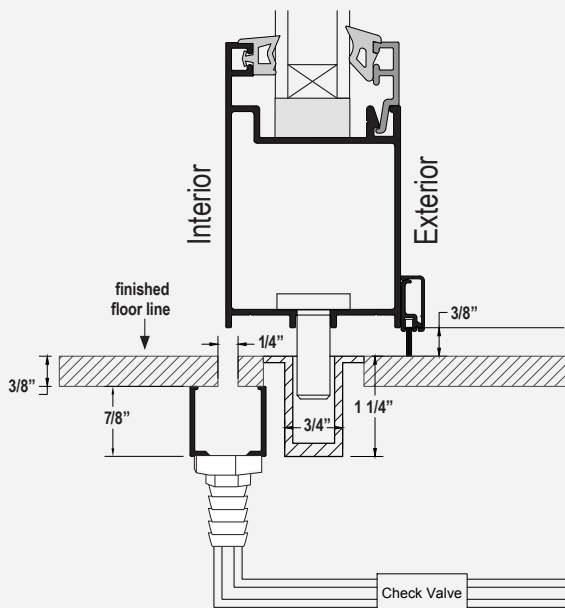
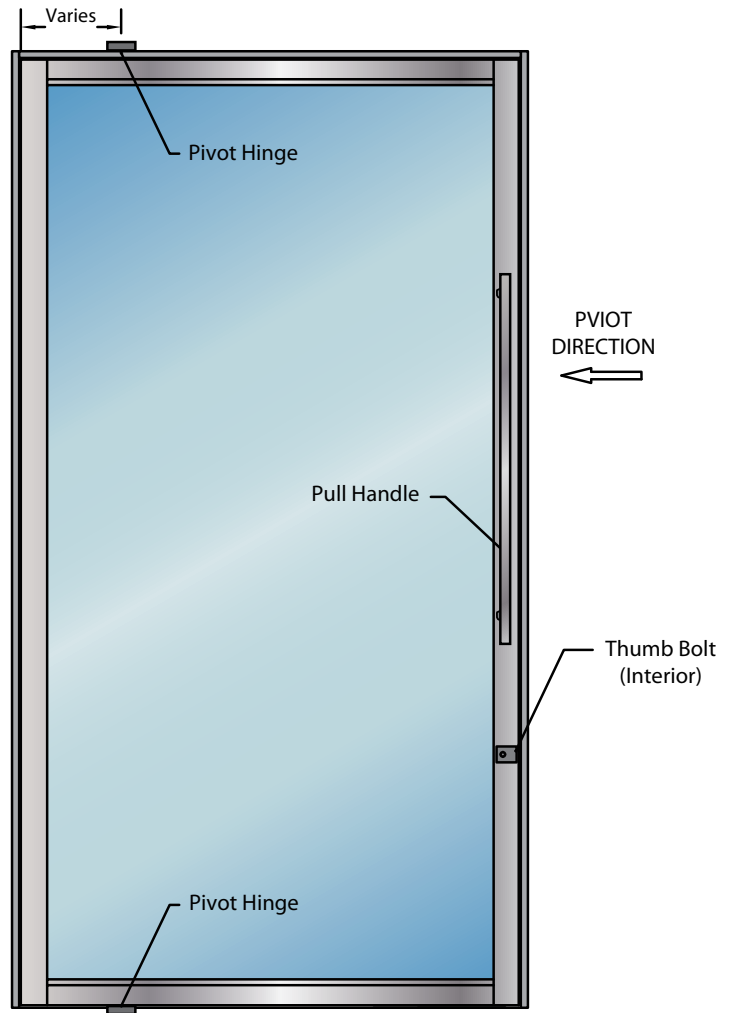
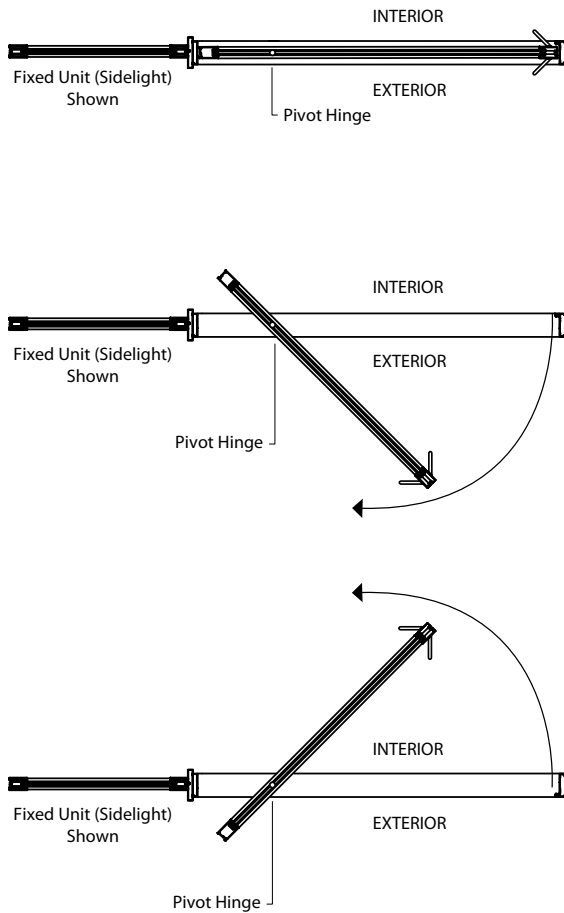

## OPTIONAL DRAINAGE SYSTEM

Euro-Wall offers an optional water management system that allows water to drain away from the pivot door location. NOTE: This is a non water rated door in the state of Florida.

# ALUMINUM & WOOD PANEL FINISH OPTIONS

## STANDARD FRAME & ALUMINUM PANEL FINISHES

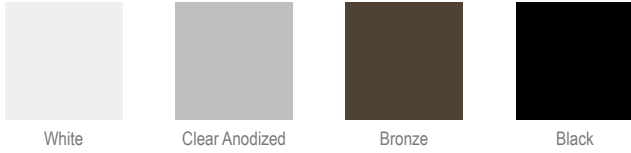

- Anodized, powder coat or Kynar® finishes available
- Custom powder coat or Kynar® finishes available
- Manufacturer color match options
- Custom wood grain finishes available

## STANDARD WOOD PANEL FINISHES



In addition to the three standard wood finishes, Euro-Wall's Euro Vista Pivot™ wood panel can be finished with a wide variety of other exotic species.

## INTERIOR WOOD CLAD FINISH OPTION

- Douglas fir
- Mahogany / sapele
- White oak
- Additional wood species available



## ALUMINUM CLAD FINISH OPTION

- White
- Clear anodized
- Bronze
- Black
- Custom colors available



# HANDLE OPTIONS

## MULTIPOINT LOCK HANDLE



### Available Finishes

- Polished Stainless Steel**
- Brushed Satin**
- Bronze**
- Black**

## TRACK / FRAME

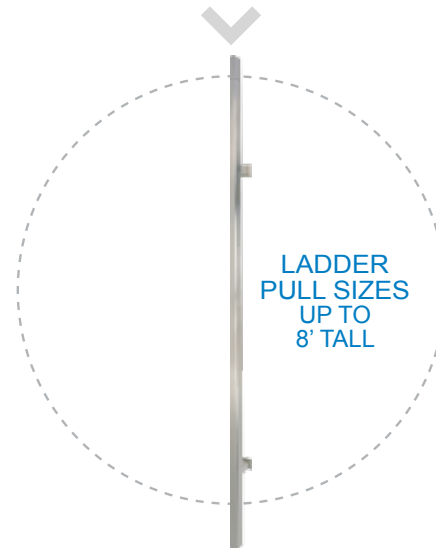

LADDER  
PULL SIZES  
UP TO  
8' TALL

### Available Finishes

- Polished Stainless Steel**
- Brushed Satin**
- Bronze**
- Black**
- Custom Colors Available*

# EURO PIVOT™ DOOR PANEL OPTIONS

The illustrations below are just a few possible design examples for the aluminum & wood Euro Pivot™ door.

**NOTE: Solid wood doors are not Florida Product Approved and are not impact rated**

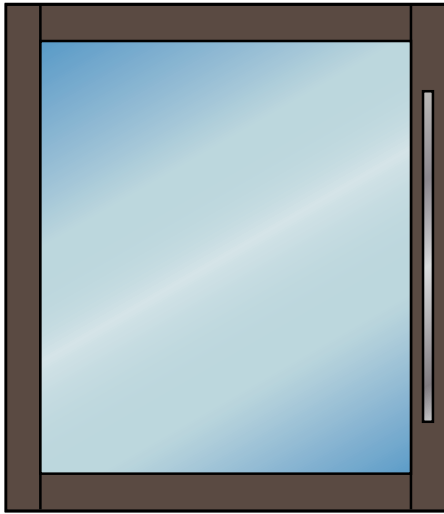

1

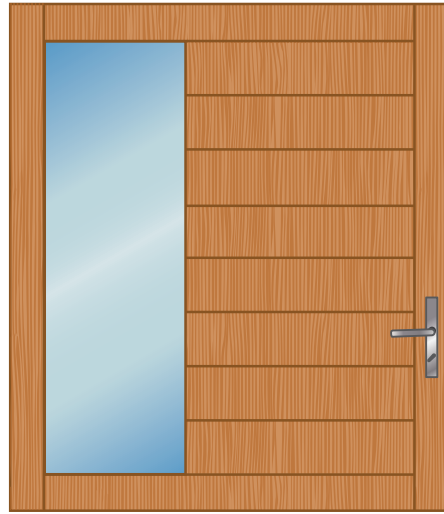

\*2

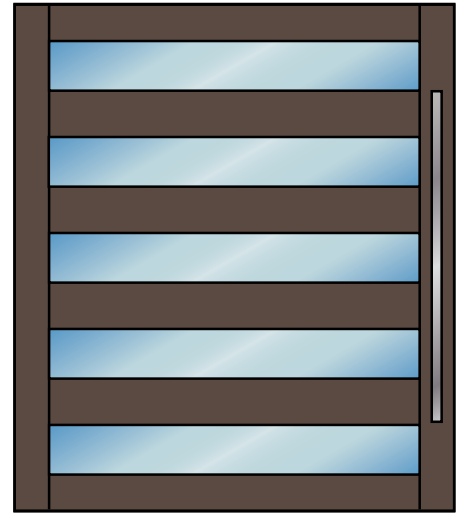

3

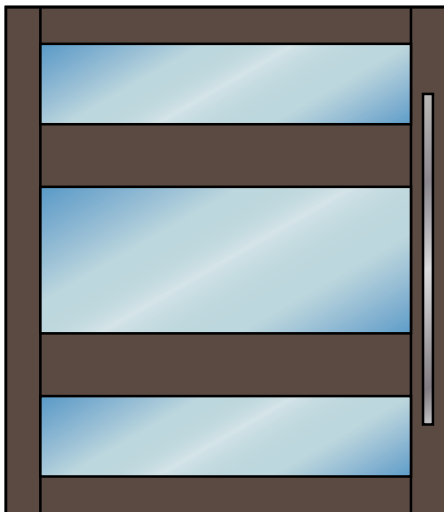

4

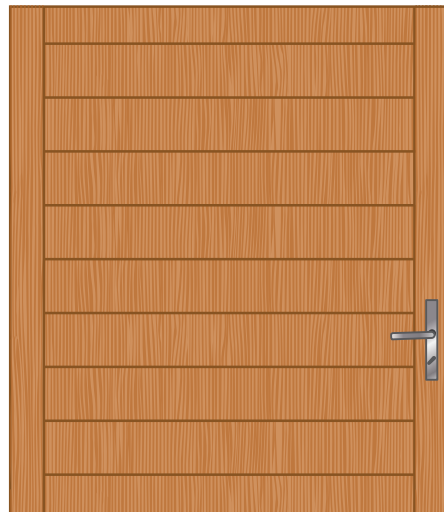

\*5

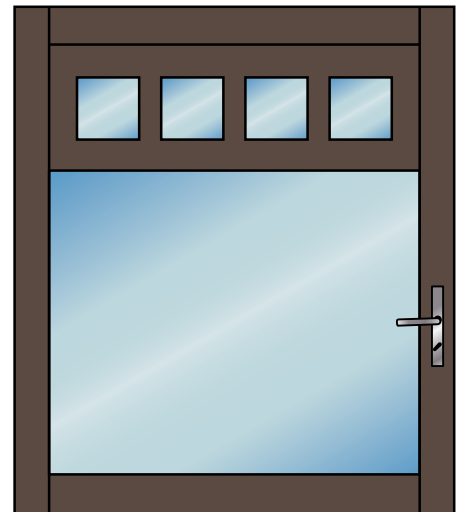

6

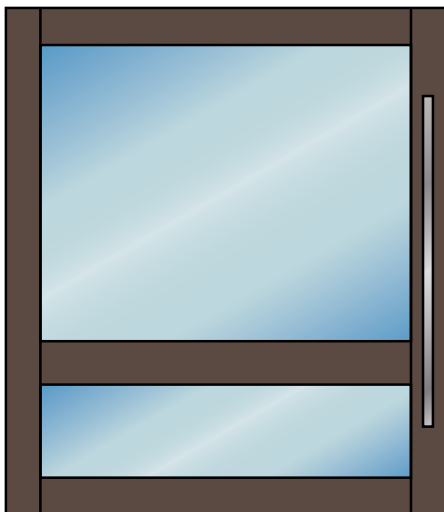

7



8

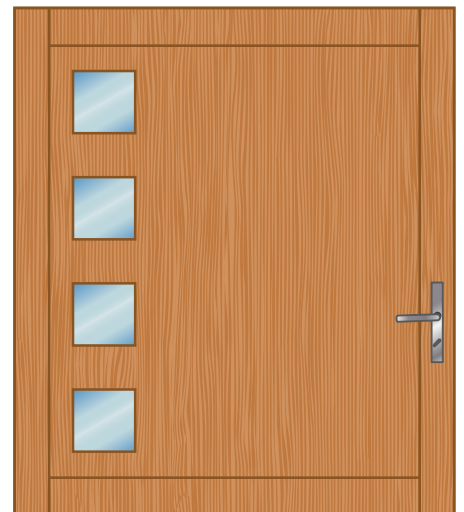

\*9

*\*Configurations 2, 5 and 9 are available in wood or wood clad ONLY. All other pivot door samples are available in aluminum or aluminum with wood clad finish.*

# PANEL & GLAZING CROSS SECTIONS

## ALUMINUM & WOOD PANEL CROSS SECTION

Outswing Extrusion Shown

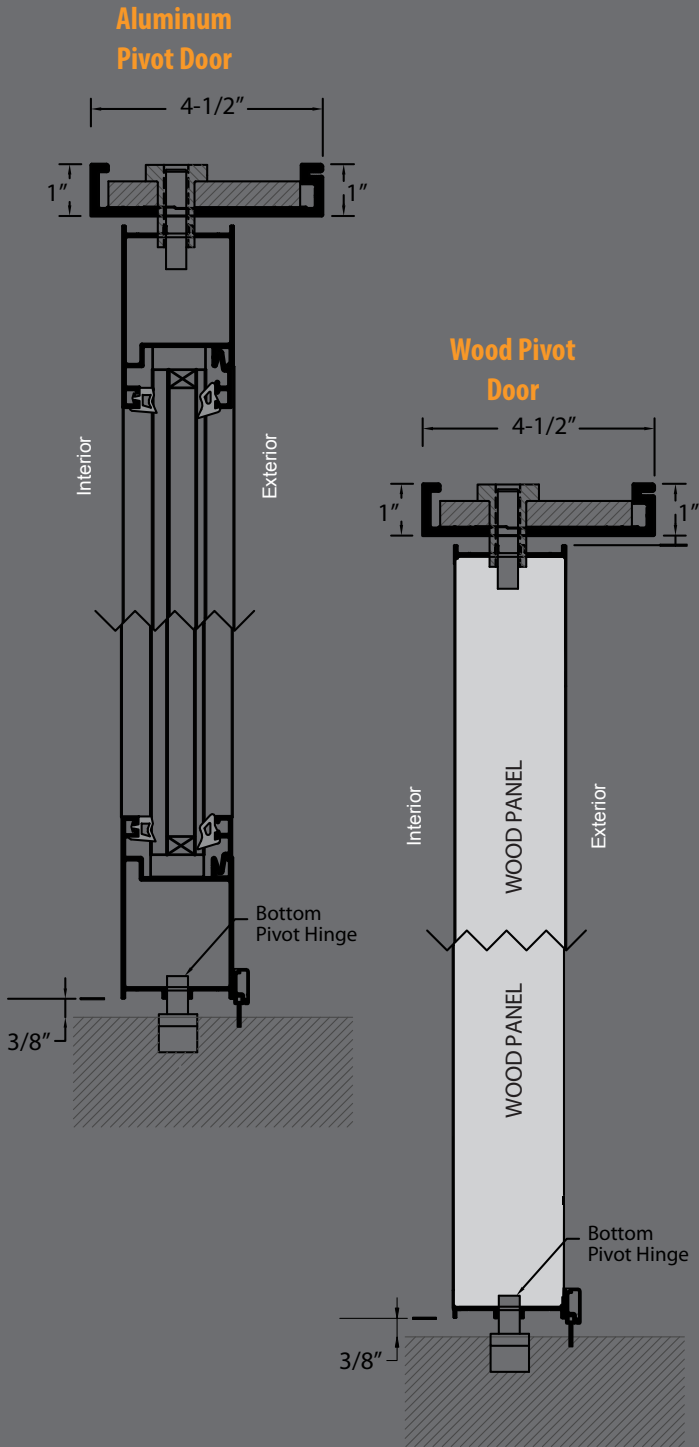

## GLAZING DETAILS

Available glass options for the Euro Vista Pivot™:

### Aluminum Pivot Door

- IG
- IG Impact
- 9/16" Impact Monolithic

### Wood Pivot Door

- 1/4" Tempered
- 1/2" Tempered
- IG
- IG Impact
- 9/16" Impact Monolithic

### Impact Glass (9/16" Monolithic)

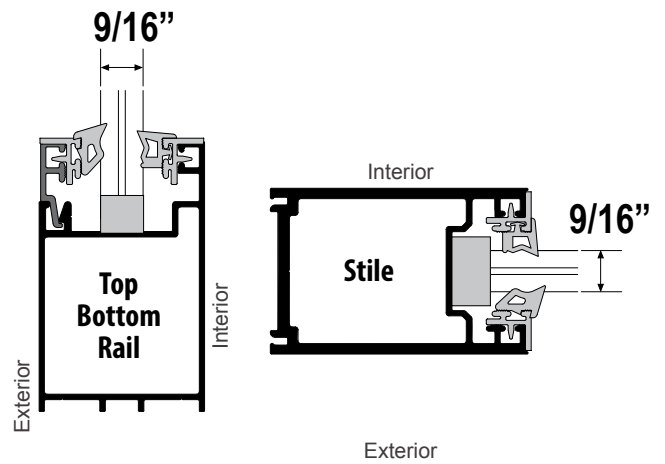

### IG Impact

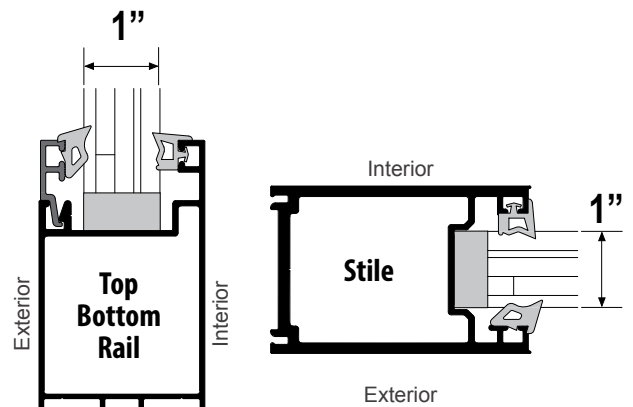

# TEST PERFORMANCES

## Aluminum Pivot Door

- Approved for use in Miami-Dade HVHZ Zone
- Florida Building Code Approved Product Approval FL 22410
- TAS 201 TAS 202 TAS 203
- AAMA / WDMA / CSA 101 / I.S.2 / A440-08 • NAFS-08
- Air Infiltration: A2
- Water Leakage Resistance: 60 DP
- Wind Load Resistance: 60 DP
- Wind Zone 4 (Hurricane) ASTM (cycling) E1996: DP60
- Wind Zone 4 (Hurricane) ASTM (impact) E1886: Pass
- Tested for Thermal Requirements

## DESIGN PRESSURE CHART

### Panel Width (Inches)

	40	44	48	50	56	60	66	69.5	72
72	60.0	60.0	60.0	60.0	60.0	60.0	60.0	60.0	60.0
78	60.0	60.0	60.0	60.0	60.0	60.0	60.0	60.0	60.0
84	60.0	60.0	60.0	60.0	60.0	60.0	60.0	60.0	60.0
90	60.0	60.0	60.0	60.0	60.0	60.0	60.0	60.0	60.0
96	60.0	60.0	60.0	60.0	60.0	60.0	60.0	60.0	60.0
102	60.0	60.0	60.0	60.0	60.0	60.0	60.0	60.0	60.0
108	60.0	60.0	60.0	60.0	60.0	60.0	60.0	60.0	60.0
114	60.0	60.0	60.0	60.0	60.0	60.0	60.0	60.0	60.0
118.375	60.0	60.0	60.0	60.0	60.0	60.0	60.0	60.0	58.5
120	60.0	60.0	60.0	60.0	60.0	60.0	58.8		
126	60.0	60.0	60.0	60.0	54.6	51.6			
132	60.0	60.0	51.5	49.7	45.0	42.5			
138	60.0	50.8	43.0	41.4	37.5				
144	60.0	42.7	36.1	34.8	31.4				

Product Approval FL 22410



## EURO-WALL 10 YEAR WARRANTY

Euro-Wall warrants the products to be free from manufacturing defects for a period of 10 years from the date of purchase.

### MANUFACTURING

2200 Murphy Court  
North Port, Florida 34289  
888.989.3876 • 941.979.5316

888.989.EURO (3876)

[www.euro-wall.com](http://www.euro-wall.com)

**euro-wall**<sup>®</sup>

FOLDING | SLIDING | STACKING

### SHOWROOM

1211 Stirling Road, Unit 102,  
Dania Beach, Florida 33004  
954.610.2572

Proud Member of the American Architectural Manufacturers Association.

